

KIMANI  
BLUEGAME BG74

The KIMANI is  
a yacht like no  
other, combining  
innovative design  
with ultimate comfort  
for an unforgettable  
experience



KIMANI ~ BLUEGAME BG74

## INFORMATION

LOA  
22.82 m (74' 10")

BEAM  
5.60 m (18' 4")

DRAFT  
16m (5' 3")

GUESTS  
6

CREW  
2

CABINS  
3

BUILT  
2025

BUILDER  
Sanlorenzo SpA (Italy)

NAVAL ARCHITECT  
Luca Santella & Zuccon  
International Project

HULL MATERIAL  
GRP

SUPERSTRUCTURE  
Open

HULL CONFIGURATION  
Planing hull



KIMANI ~ BLUEGAME BG74

## KEY FEATURES

1

The brand-new Bluegame yacht

2

These are the sample photos

3

KIMANI offers simplicity, easy maneuverability, comfort, and safety during navigation

4

She features a cockpit with 360° visibility, a first-of-its-kind innovation for an open yacht

5

The yacht offers expansive outdoor spaces, including a beach area, spacious living/dining area, adaptable bow, and easily accessible sundeck





"KIMANI" is a revolutionary yacht that blends the BG range's open layout with the BGX series flybridge concept, creating a truly unique design.

Expertly crafted by Luca Santella, she features a high-performance hull designed by Lou Codega and is powered by a Volvo IPS propulsion system, ensuring superior performance and fuel efficiency.

The yacht's cockpit offers an impressive 360° visibility, complemented by an inverted windscreen and the option for full closure, providing privacy or protection.

With interior and exterior spaces designed by Zuccon International Project, "KIMANI" is both stylish and functional.

She boasts expansive outdoor areas across three levels, featuring a beach area, a spacious living/dining space, a versatile bow, and an easily accessible sundeck, providing guests with multiple luxurious spots to fully enjoy the sea.

Inside, she offers 3 elegant en-suite cabins accommodating up to 6 guests, with a professional crew of 2 dedicated to delivering an exceptional, personalized experience throughout the journey.



KIMANI ~ BLUEGAME BG74

GALLERY



Galley

KIMANI ~ BLUEGAME BG74

GALLERY



Master cabin



KIMANI ~ BLUEGAME BG74

GALLERY



Twin cabin

KIMANI ~ BLUEGAME BG74

GALLERY



Bathroom



KIMANI ~ BLUEGAME BG74

## TEHNICAL SPECIFICATIONS

### LOA

22.82 m (74' 10")

### BEAM

5.60 m (18' 4")

### DRAFT

1.6m (5' 3")

### GUESTS

6

### CABINS

3

### CABIN CONFIGURATION

1double, 2 twin  
(can be converted)

### BED CONFIGURATION

1 King, 4 single or 3 king  
(as 4 single beds can  
be converted into  
2 double beds)

### ENGINES

2 X VOLVO PENTA IPS  
1350 D13/ 2 X 735 KW/  
1000 HP STD

### GENERATORS

Kohler

### FUEL CONSUMPTION

220 Litres/Hr (cruising),  
380 Litres/Hr (max),  
130 Litres/Hr (eco)

### CRUISING SPEED

24 kts

### MAX SPEED

30 kts

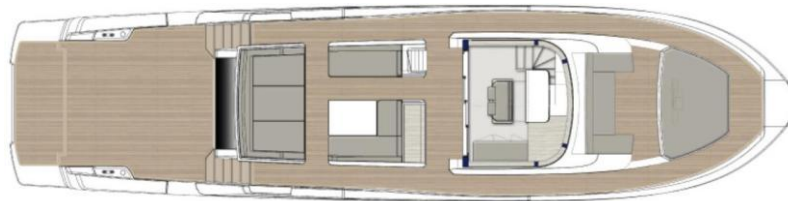

KIMANI ~ BLUEGAME BG74  
TENDER & SEA TOYS / EQUIPMENT

> AGILIS Jet Tender 305C,  
for 4 persons, 90 HP/topspeed 37 knots

Jet ski RXP-X\* RS 325

Snorkeling gear

- > Air conditioning
- > Stabilisers at anchor
- > Stabilisers underway

WiFi connection



KIMANI  
BLUEGAME BG74



We invite you  
to discover  
fascinating  
Croatia with us!